

SBRT SOLUTION ARM REST SUPPORT PLATE



Article No. : 32317/6

A. GENERAL PRODUCT INFORMATION

The products referred to in these instructions are medical devices, used for patient positioning and immobilisation in radiation therapy. This plate can be used during both the simulation and the treatment stage, including MRI simulation. This product may only be used in combination with Orfit immobilisation products. Orfit prohibits the use of unauthorised third-party products in conjunction with its own products.

B. PRODUCT DESCRIPTION

This arm rest plate is attached to the SBRT BASE PLATE and functions as an indexation device for the ARM REST CUSHIONS and GRIP POLES. Information on these other parts can be found in the respective 'instructions for use' and on www.orfit.com.

C. INSTALLATION

1. The arm rest plate is attached to the pins on the cranial section of the SBRT base plate.

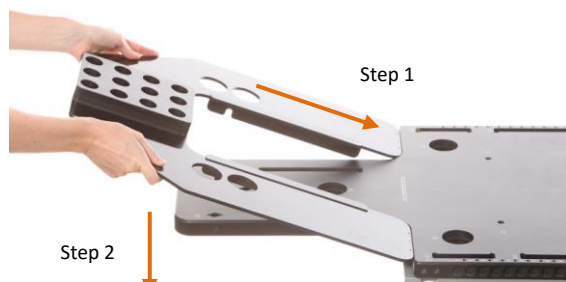

2. Two holes are located on the right and left side of the arm rest plate to position the arm rest cushion. There is a cranial and caudal position for the cushion. Choose the one that is the most suitable for your patient.



3. The block with holes at the cranial end of the plate is used to position the grip poles. Several indexed locations are provided. This gives the possibility to use two grip poles, one for each hand, or only one for both hands.

D. STORAGE

Always store the product in a safe place to prevent it from getting damaged.

Store the frame between +10°C (50°F) and 40°C (122°F).

E. PROPERTIES



E.1. Physical Properties

Dimensions: 585,5 mm L x 540 mm W x 52,5 mm H
 Weight: 1.91 kg
 Material: High Pressure Laminate

This product is made entirely of electrically non-conductive, non-metallic and non-magnetic materials and is MRI safe.



E.2. Mechanical Properties

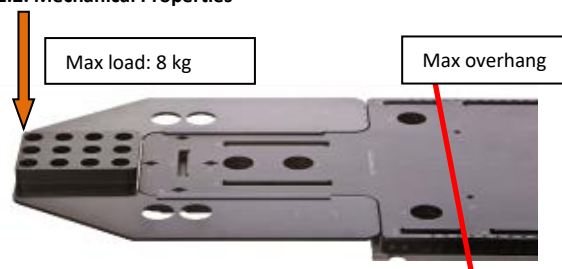

The arm rest plate adds 197,5 mm (7,77 inches) to the total length of the SBRT system which then is 2470,5 mm long (8,10 feet).

F. MAINTENANCE AND WASTE MANAGEMENT

This product can be cleaned and disinfected by means of soapy water or an isopropanol based disinfectant, applied with a soft cloth. If unsure about the cleaning fluid, do not use. **Never use aerosol sprays, corrosive cleaning agents, solvents or abrasive detergents.**

Periodic checks of the product should be done to insure the parts are not worn and require repair or replacement. **Do not**

attempt to make repairs yourself. Contact your distributor if there are any questions or concerns.
The product can be disposed of with household waste.

G. ADDITIONAL INFORMATION

For additional information such as distributor contact information, product brochures, Safety Data Sheets and regulatory information, please visit our website www.orfit.com.

Note:

It is prohibited to make alterations to this text without prior approval from Orfit Industries.



ORFIT INDUSTRIES
Vosveld 9A | B-2110 Wijnegem | Belgium
T (+32) (0)3 326 20 26
welcome@orfit.com

www.orfit.com



Ref. No. 50043
VERSION 3
LAST UPDATE: 02/04/2021
REVISION DATE: 02/04/2023